

EVAN ROTH'S RED LINES

WITH LANDSCAPES AT THE USHER GALLERY

01 June–15 September 2019

Exhibition Guide

Gallery Map

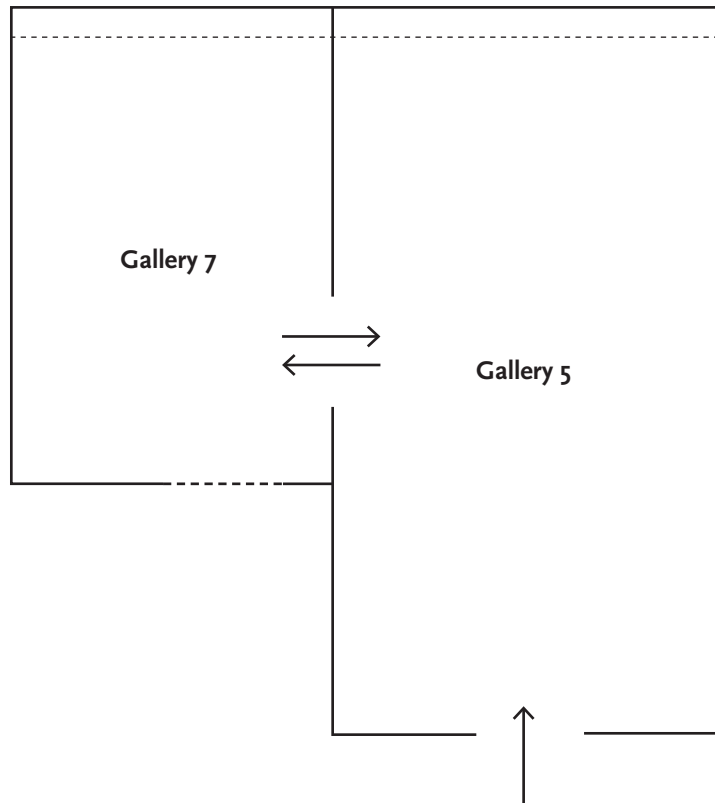

This exhibition presents American artist Evan Roth's Artangel 2018 commission, *Red Lines*, streamed via the internet from coastal sites around the world directly into the gallery, alongside works from The Usher Gallery's landscape collection.

Roth's *Red Lines* project is a network of mesmerising video landscapes, filmed in infrared from sites around the world where the cables that make the internet possible emerge from the sea.

For this exhibition, Roth has personally selected works from the museum's collection of 18th and 19th century landscape paintings and sketches, including work by Peter DeWint, J.M.W. Turner and Edward Lear.

By contrasting the old and the new, this exhibition explores the history, power structures and ideologies that shape our visible and non-visible contemporary landscape.

Red Lines furthers Roth's exploration of another side of the internet, one that moves at the speed of the weather, wind and tide. In this age of immediacy, visitors are invited to take time to look slowly at these different presentations of landscape.

About Evan Roth

Evan Roth (b.1978, Michigan, USA) was selected as part of the 2017 Artangel Everywhere open call for proposals to produce a major project that can be experienced anywhere in the world.

Based in Berlin, Roth's practice visualizes and archives typically unseen aspects of rapidly changing communication technologies. Through a range of media from sculpture to websites, the work addresses the personal and cultural effects surrounding these changes and the role of individual agency within the media landscape.

Roth is the co-founder of the Graffiti Research Lab and the Free Art & Technology Lab (F.A.T. Lab) and his work has been exhibited at the Tate and Whitechapel Gallery and is in the permanent collection of the Museum of Modern Art NYC.

Gallery 5

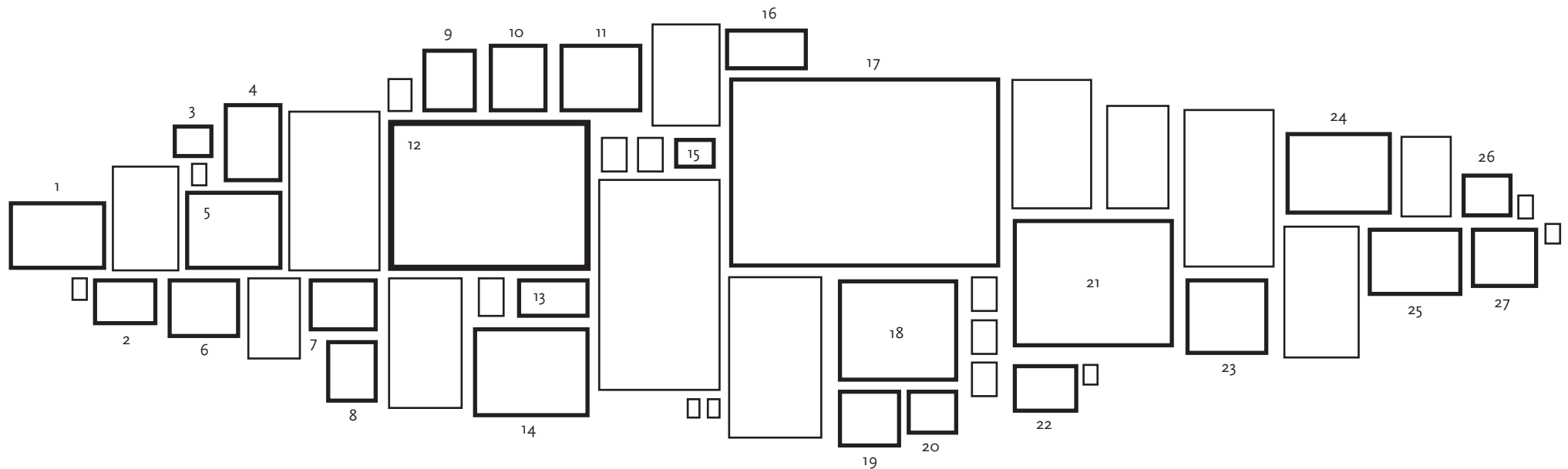

Works from The Usher Gallery's collection:

1. Peter DeWint, *View in Gloucestershire*, c.19th century. LCNUG: 1927/762
2. Alfred Stannard, *Fenland Landscape*, c.19th century. LCNUG: 2013/1
3. Edward Lear, *Turbia*, c.19th century. LCNUG: 2008/17
4. Peter DeWint, *Study of a Tree*, c.19th century. LCNUG: 1927/884
5. David Cox, *Welsh Landscape*, c.19th century. LCNUG: 1927/1525
6. Peter DeWint, *A Drover at the Edge of a Wood, Lincoln in the Distance*, c.1830. LCNUG: 1995/5
7. Jose Weiss, *Landscape*, c.19th century. LCNUG: 1927/952
8. William P Sherlock, *Landscape with Castle and River*, c.18th century. LCNUG: 1927/1532
9. Jean Henri De-Coene, *Landscape*, c.19th century. LCNUG: 1927/912
10. Unknown artist, Norwich School, *Tree Study*, c.19th century. LCNUG: 1927/1534
11. Jean Henri De-Coene, *River Scene with Men in a Boat*, c.19th century. LCNUG: 1927/909
12. Joseph Mallord William Turner, *Lincoln*, c.1802–3. LCNUG: 1927/2379
13. Edward R Taylor, *Lincoln Cathedral from the Witham*, c.19th century. LCNUG: 1927/2597
14. Edmund John Niemann, *Lincoln from The Holmes*, c.1860. LCNUG: 1927/2180
15. Peter DeWint, *The Burning of the Houses of Parliament*, 1834. LCNUG: 1927/1962
16. Edmund John Niemann, *Distant View of Lincoln*, 1857. LCNUG: 1980/1
17. Peter DeWint, *Landscape with Castle*, c.19th century. LCNUG: 1927/675
18. Unknown artist, *Landscape with Castle*, c.18th–19th century. LCNUG: 1927/2635
19. Peter DeWint, *Landscape with Cows*, c.19th century. LCNUG: 1927/2444
20. Herbert Rollett, *Blue Sky*, c.18th–19th century. LCNUG: 1996/22
21. George Barrett, *View in the Wye Valley*, c.18th century. LCNUG: 1927/937
22. Alfred George Webster, *Mablethorpe Shore*, c.19th century. LCNUG: 1927/2148
23. Ludwig or Nicholas van Schoor, *Landscape with Tree*, c.17th century. LCNUG: 1927/1531
24. James Bourne, *Remains of the Manor at Belleau*, Lincolnshire, c.18th century. LCNUG: 1927/1941
25. Peter DeWint, *Aylesbury*, c.19th century. LCNUG: 1927/2433
26. John Varley, *Skipton, Yorkshire*, c.18th–19th century. LCNUG: 1927/774
27. William Shayer, *Landscape with Ruined Castle*, c.19th century. LCNUG: 1927/1537

Gallery 5 (continued)

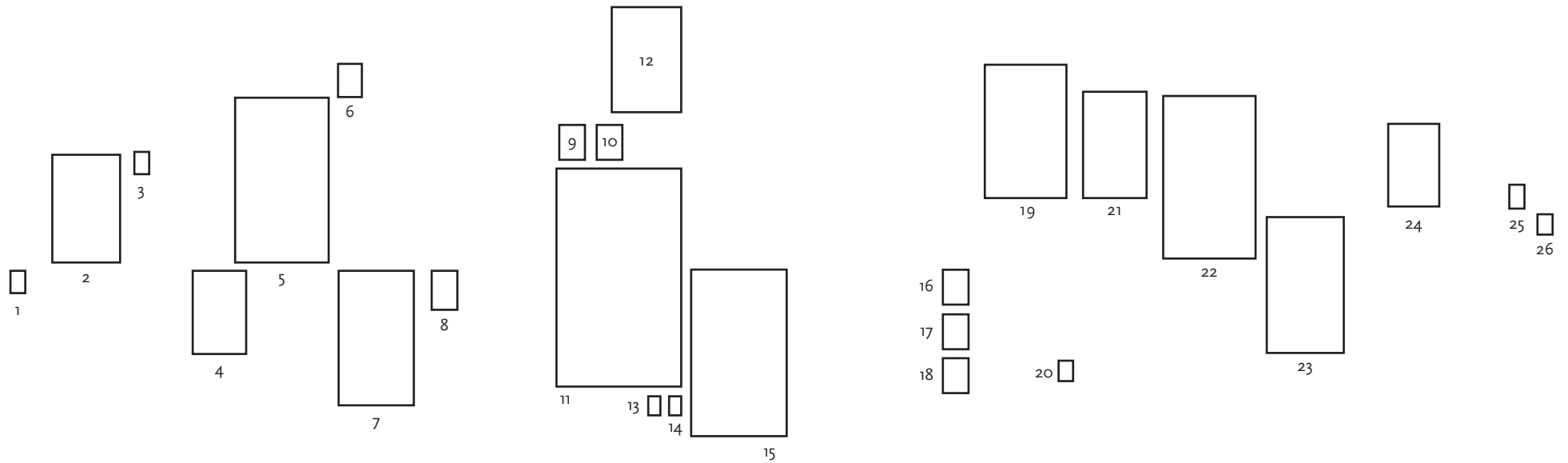

Screens

Monitor #1 n57.889503e11.685638.se
Monitor #2 n19.133055e72.794722
Monitor #3 s36.810855e174.422624.co.nz
Monitor #4 s36.787854e174.775050.co.nz
Monitor #5 n50.204520e1.538171.fr
Monitor #6 n22.215719e114.248988.hk
Monitor #7 n59.329736e18.132242.se
Monitor #8 s33.806901e151.299299.com.au
Monitor #9 s36.506111w56.713333.com.ar
Monitor #10 s33.820180e151.184813.com.au
Monitor #11 n19.132919e72.795862.in
Monitor #12 n22.208606e114.256798.hk
Monitor #13 s33.943225e18.394233.co.za

Monitor #14 s33.898239e151.275644.com.au
Monitor #15 s36.611388w56.706666.com.ar
Monitor #16 s33.806901e151.299299.com.au
Monitor #17 s36.479351w56.697737.com.ar
Monitor #18 n22.207525e114.258659.hk
Monitor #19 n50.044264w5.649649.co.uk
Monitor #20 n22.208606e114.256798.hk
Monitor #21 s33.953939e18.375759.co.za
Monitor #22 s33.336681e18.160858.co.za
Monitor #23 s33.851451e151.286459.com.au
Monitor #24 n50.134386w5.703133.co.uk
Monitor #25 s36.479351w56.697737.com.ar
Monitor #26 s33.953625e18.375743.co.za

Gallery 7

Works from The Usher Gallery's collection:

Peter DeWint, *Landscape with Rainbow*,
c.19th century. LCNUG: 1927/681

Pieces on rotation on screen:

n19.000385e72.860211.in	18:00
n19.000566e72.860226.in	14:05
n19.019361e72.824661.in	18:00
n19.026198e72.815537.in	18:00
n19.042222e72.819166.in	12:27
n19.106199e72.860296.in	12:39
n19.131760e72.795009.in	7:20
n19.132919e72.795862.in	18:00
n19.133055e72.794722.in	18:00